

CTJ-5 5 GALLON JACKETED GLASS-LINED STEEL REACTOR

Specifications

| | |
|-------------------------------|-------------------------|
| Vessel Design Pressure (psig) | 150 and F.V. |
| Jacket Design Pressure (psig) | 150 or 150 w/ Int. F.V. |
| Design Temperature (°F) | 500 |
| Jacket Heating Area (sq. ft.) | 1 |

Dimensions (inches)

| | |
|-----------------------|--------------------------------|
| A | 9 ³ / ₄ |
| B | 9 ¹ / ₂ |
| C | 23 ¹ / ₈ |
| D | 78 ¹ / ₈ |
| E | 6 ¹ / ₂ |
| F (I.D.) | 13 ¹ / ₄ |
| G (O.D.) | 18 |
| H (nozzle elevations) | 4 |

Capacity (gallons)

| | |
|------------------------|-----|
| Working | 5 |
| Total Volume | 8.1 |
| Head Volume | 1.3 |
| Per Inch Straight Side | .57 |
| Jacket | 3 |

Weight (pounds)

| | |
|------------------------------|-----|
| Bare Body (no accessories) | 355 |
| Complete (with drive system) | 570 |
| Add for Shipping | 150 |

Lenze® Helical Gear Drive

| | |
|-------------------|----------------|
| Motor | 1HP |
| Motor Type | XP |
| Drive Size | GST05-2N-VCR5D |
| • Low Noise Level | |

Retreat Curve Impeller Agitator

| | |
|------------------------|---------|
| Span (inches) | 8 |
| Speed (standard speed) | 214 RPM |

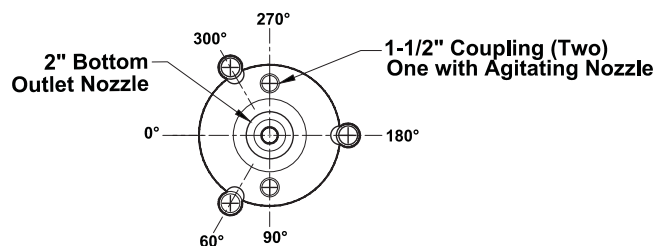
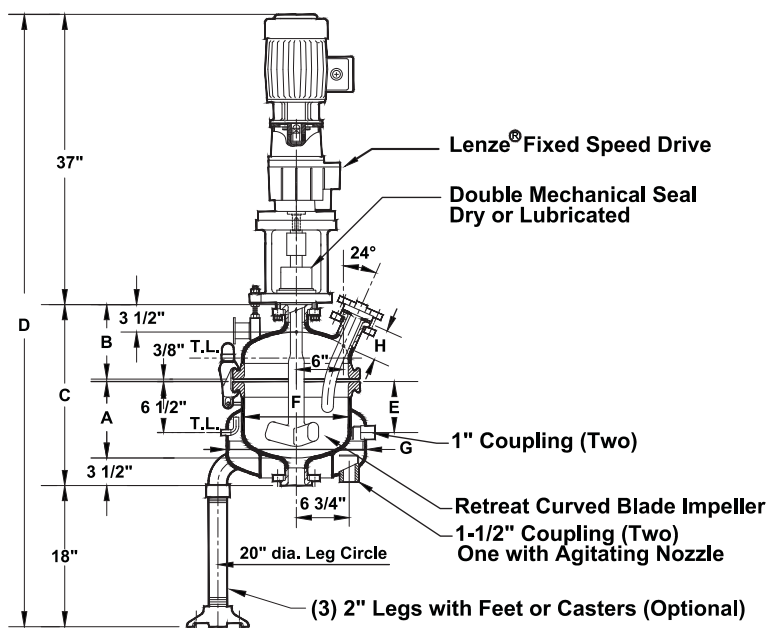
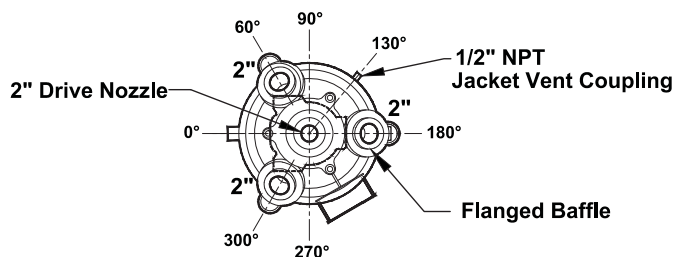

CTJ-10

10 GALLON JACKETED GLASS-LINED STEEL REACTOR

Specifications

| | |
|-------------------------------|-------------------------|
| Vessel Design Pressure (psig) | 150 and F.V. |
| Jacket Design Pressure (psig) | 150 or 150 w/ Int. F.V. |
| Design Temperature (°F) | 500 |
| Jacket Heating Area (sq. ft.) | 3.9 |

Dimensions (inches)

| | |
|-----------------------|--------------------------------|
| A | 16 ³ / ₄ |
| B | 9 ¹ / ₂ |
| C | 30 ¹ / ₈ |
| D | 85 ¹ / ₈ |
| E | 6 ¹ / ₂ |
| F (I.D.) | 13 ¹ / ₄ |
| G (O.D.) | 18 |
| H (nozzle elevations) | 4 |

Capacity (gallons)

| | |
|-------------------------------|------|
| Working | 10 |
| Total Volume | 11.9 |
| Head Volume | 1.3 |
| Per Inch Straight Side Jacket | .57 |
| Jacket | 6 |

Weight (pounds)

| | |
|------------------------------|-----|
| Bare Body (no accessories) | 415 |
| Complete (with drive system) | 630 |
| Add for Shipping | 150 |

Lenze® Helical Gear Drive

| | |
|-------------------|-----------------|
| Motor | 1HP |
| Motor Type | XP |
| Drive Size | GST05 2N VCR 5D |
| • Low Noise Level | |

Retreat Curve Impeller Agitator

| | |
|------------------------|---------|
| Span (inches) | 8 |
| Speed (standard speed) | 214 RPM |

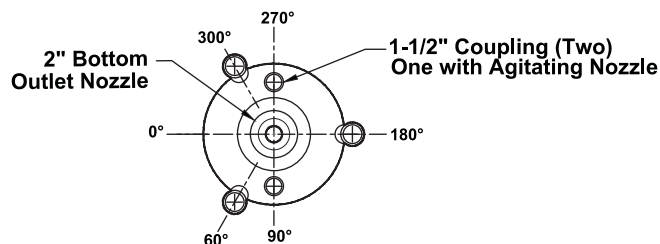
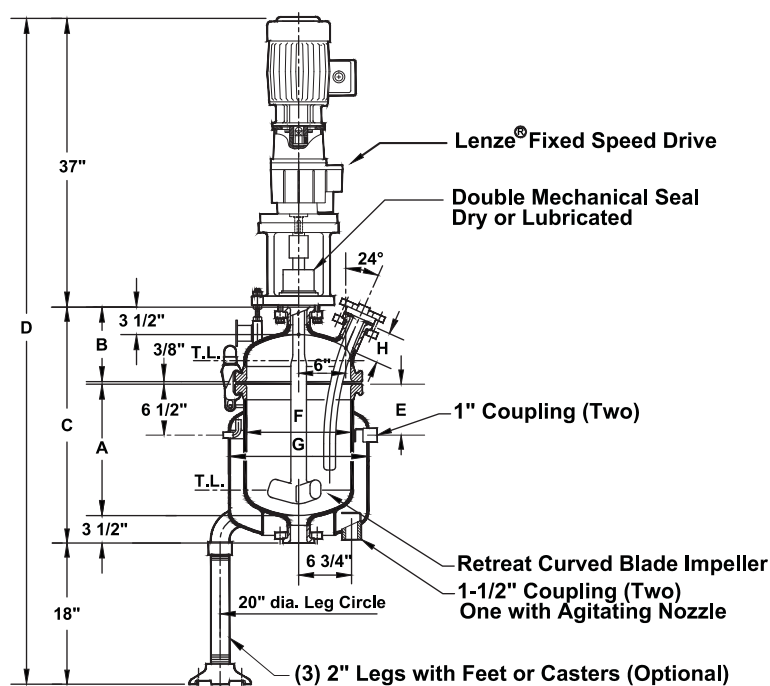
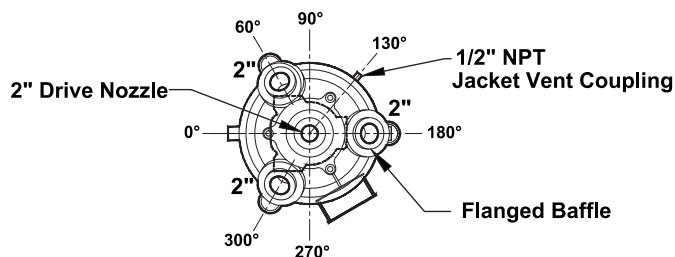

CTJ-20

20 GALLON JACKETED GLASS-LINED STEEL REACTOR

Specifications

| | |
|-------------------------------|----------------------------|
| Vessel Design Pressure (psig) | 150 and F.V. |
| Jacket Design Pressure (psig) | 115 or 100 w/ Int. F.V. |
| Design Temperature (°F) | 500 |
| Jacket Heating Area (sq. ft.) | 8.5 |

Dimensions (inches)

| | |
|-----------------------|----------------------------------|
| A | 19 ⁵ / ₁₆ |
| B | 6 |
| C | 28 ¹¹ / ₁₆ |
| D | 84 ¹³ / ₁₆ |
| E | 4 ⁵ / ₈ |
| F (I.D.) | 19 ¹ / ₄ |
| G (O.D.) | 23 ⁵ / ₈ |
| H (nozzle elevations) | |
| 1 1/2" nozzle | 5 |
| 2" nozzles | 5 ¹ / ₂ |
| J (nozzle radius) | |
| 1 1/2" nozzle | 7 ¹ / ₄ |
| 2" nozzles | 7 ³ / ₄ |

Capacity (gallons)

| | |
|------------------------|------|
| Working | 20 |
| Total Volume | 24 |
| Head Volume | 3 |
| Per Inch Straight Side | 1.25 |
| Jacket | 8 |

Weight (pounds)

| | |
|------------------------------|-----|
| Bare Body (no accessories) | 725 |
| Complete (with drive system) | 940 |
| Add for Shipping | 150 |

Lenze® Helical Gear Drive

| | |
|-------------------|-----------------|
| Motor | 1.5HP |
| Motor Type | XP |
| Drive Size | GST05 2N VCR 5D |
| • Low Noise Level | |

Pitch Blade Turbine Agitator

| | |
|------------------------|---------|
| Span (inches) | 10 |
| Speed (standard speed) | 214 RPM |
| • Clockwise Rotation | |

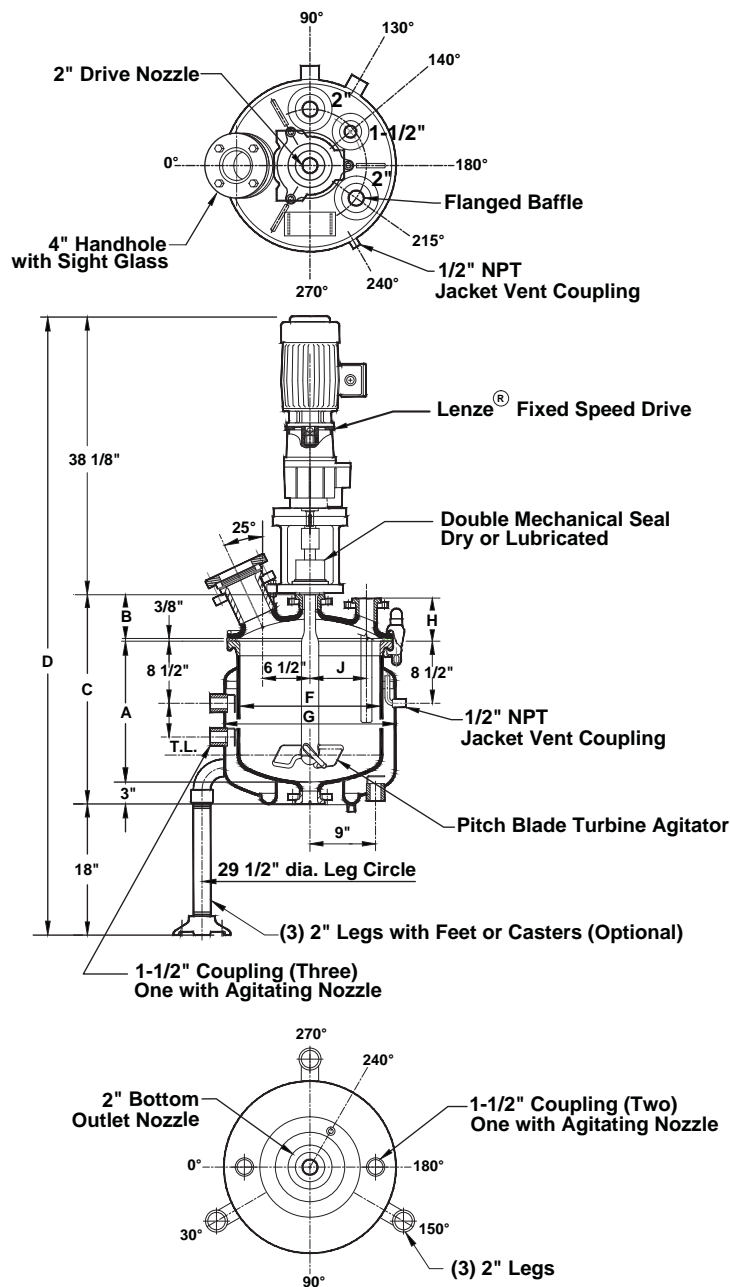

CTJ-20

20 GALLON JACKETED GLASS-LINED STEEL REACTOR

Specifications

| | |
|-------------------------------|----------------------------|
| Vessel Design Pressure (psig) | 150 and F.V. |
| Jacket Design Pressure (psig) | 115 or 100 w/ Int. F.V. |
| Design Temperature (°F) | 500 |
| Jacket Heating Area (sq. ft.) | 8.5 |

Dimensions (inches)

| | |
|--|----------------------------------|
| A | 19 ⁵ / ₁₆ |
| B | 6 |
| C | 28 ¹¹ / ₁₆ |
| D | 84 ¹³ / ₁₆ |
| E | 4 ⁵ / ₈ |
| F (I.D.) | 19 ¹ / ₄ |
| G (O.D.) | 23 ⁵ / ₈ |
| H (nozzle elevations) | |
| 1 ¹ / ₂ " nozzle | 5 |
| 2" nozzles | 5 ¹ / ₂ |
| J (nozzle radius) | |
| 1 ¹ / ₂ " nozzle | 7 ¹ / ₄ |
| 2" nozzles | 7 ³ / ₄ |

Capacity (gallons)

| | |
|------------------------|------|
| Working | 20 |
| Total Volume | 24 |
| Head Volume | 3 |
| Per Inch Straight Side | 1.25 |
| Jacket | 8 |

Weight (pounds)

| | |
|------------------------------|-----|
| Bare Body (no accessories) | 636 |
| Complete (with drive system) | 850 |
| Add for Shipping | 150 |

Lenze® Helical Gear Drive

| | |
|-------------------|-----------------|
| Motor | 1.5HP |
| Motor Type | XP |
| Drive Size | GST05 2N VCR 5D |
| • Low Noise Level | |

Retreat Curve Impeller Agitator

| | |
|-----------------------------|---------|
| Span (inches) | 16 |
| Speed (standard speed) | 214 RPM |
| • Counterclockwise Rotation | |

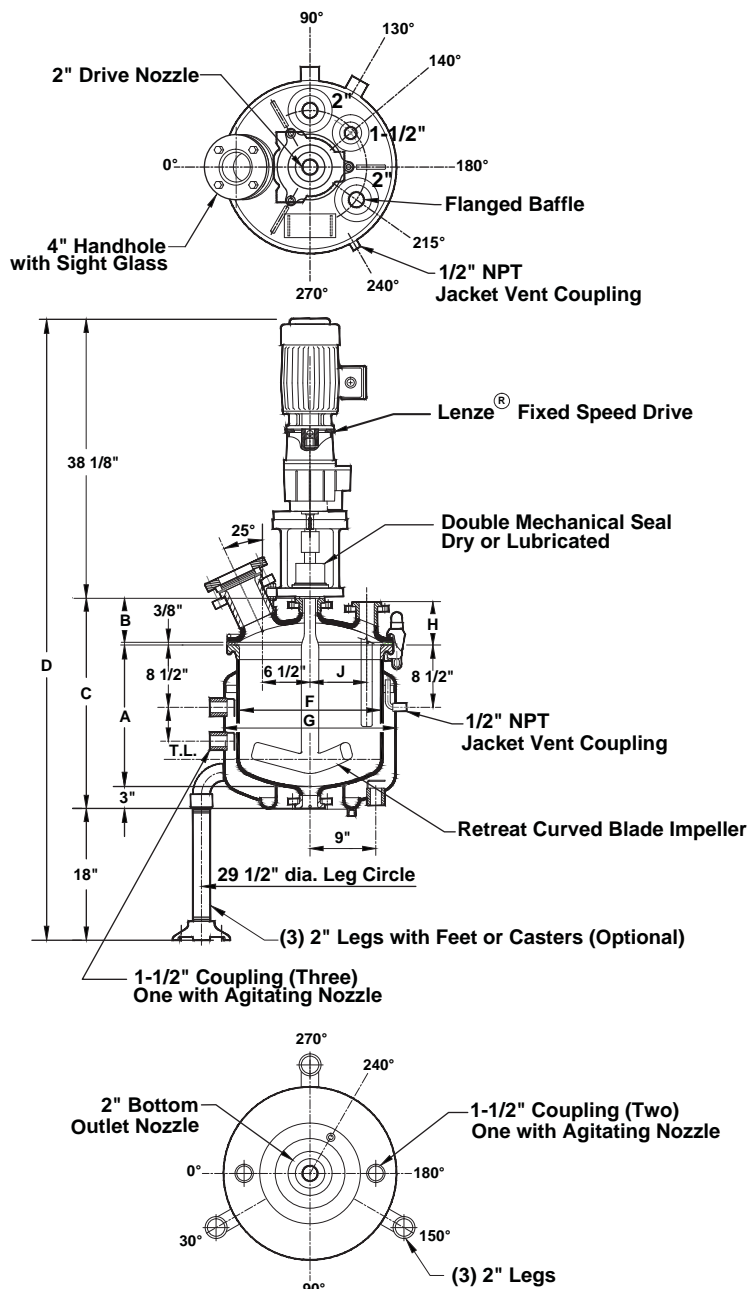

CTJ-30

30 GALLON JACKETED GLASS-LINED STEEL REACTOR



Specifications

| | |
|-------------------------------|----------------------------|
| Vessel Design Pressure (psig) | 150 and F.V. |
| Jacket Design Pressure (psig) | 115 or 100 w/ Int. F.V. |
| Design Temperature (°F) | 500 |
| Jacket Heating Area (sq. ft.) | 12 |

Dimensions (inches)

| | |
|-----------------------|----------------------------------|
| A | 27 ³ / ₁₆ |
| B | 6 |
| C | 36 ⁹ / ₁₆ |
| D | 92 ¹¹ / ₁₆ |
| E | 12 ¹ / ₂ |
| F (I.D.) | 19 ¹ / ₄ |
| G (O.D.) | 23 ⁵ / ₈ |
| H (nozzle elevations) | |
| 1 1/2" nozzle | 5 |
| 2" nozzles | 5 1/2 |
| J (nozzle radius) | |
| 1 1/2" nozzle | 7 1/4 |
| 2" nozzles | 7 3/4 |

Capacity (gallons)

| | |
|------------------------|------|
| Working | 30 |
| Total Volume | 34 |
| Head Volume | 3 |
| Per Inch Straight Side | 1.25 |
| Jacket | 12 |

Weight (pounds)

| | |
|------------------------------|-----|
| Bare Body (no accessories) | 763 |
| Complete (with drive system) | 967 |
| Add for Shipping | 150 |

Lenze® Helical Gear Drive

| | |
|-------------------|-----------------|
| Motor | 1.5HP |
| Motor Type | XP |
| Drive Size | GST05 2N VCR 5D |
| • Low Noise Level | |

Pitch Blade Turbine Agitator

| | |
|------------------------|---------|
| Span (inches) | 10 |
| Blade Angle | 45° |
| Speed (standard speed) | 214 RPM |
| • Clockwise Rotation | |

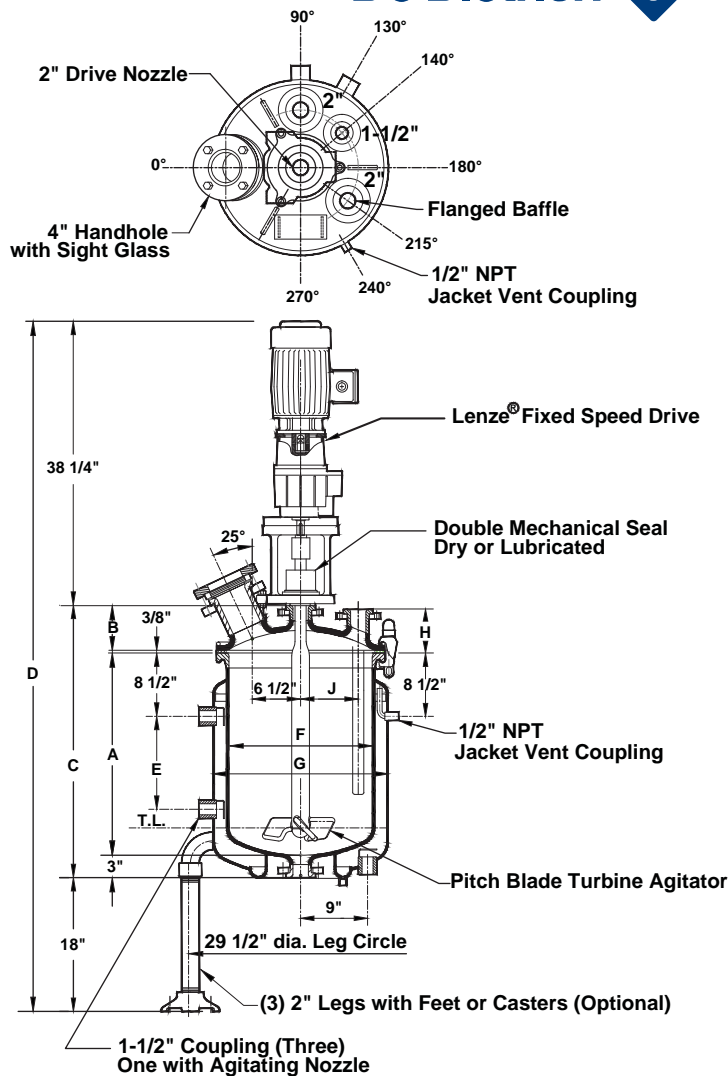

CTJ-30

30 GALLON JACKETED GLASS-LINED STEEL REACTOR

Specifications

| | |
|-------------------------------|----------------------------|
| Vessel Design Pressure (psig) | 150 and F.V. |
| Jacket Design Pressure (psig) | 115 or 100 w/ Int. F.V. |
| Design Temperature (°F) | 500 |
| Jacket Heating Area (sq. ft.) | 12 |

Dimensions (inches)

| | |
|--|----------------------------------|
| A | 27 ³ / ₁₆ |
| B | 6 |
| C | 36 ⁹ / ₁₆ |
| D | 92 ¹¹ / ₁₆ |
| E | 12 ¹ / ₂ |
| F (I.D.) | 19 ¹ / ₄ |
| G (O.D.) | 23 ⁵ / ₈ |
| H (nozzle elevations) | |
| 1 ¹ / ₂ " nozzle | 5 |
| 2" nozzles | 5 ¹ / ₂ |
| J (nozzle radius) | |
| 1 ¹ / ₂ " nozzle | 7 ¹ / ₄ |
| 2" nozzles | 7 ³ / ₄ |

Capacity (gallons)

| | |
|------------------------|------|
| Working | 30 |
| Total Volume | 34 |
| Head Volume | 3 |
| Per Inch Straight Side | 1.25 |
| Jacket | 12 |

Weight (pounds)

| | |
|------------------------------|-----|
| Bare Body (no accessories) | 763 |
| Complete (with drive system) | 967 |
| Add for Shipping | 150 |

Lenze® Helical Gear Drive

| | |
|-------------------|-----------------|
| Motor | 1.5HP |
| Motor Type | XP |
| Drive Size | GST05 2N VCR 5D |
| • Low Noise Level | |

Retreat Curve Impeller Agitator

| | |
|-----------------------------|---------|
| Span (inches) | 16 |
| Speed (standard speed) | 214 RPM |
| • Counterclockwise Rotation | |

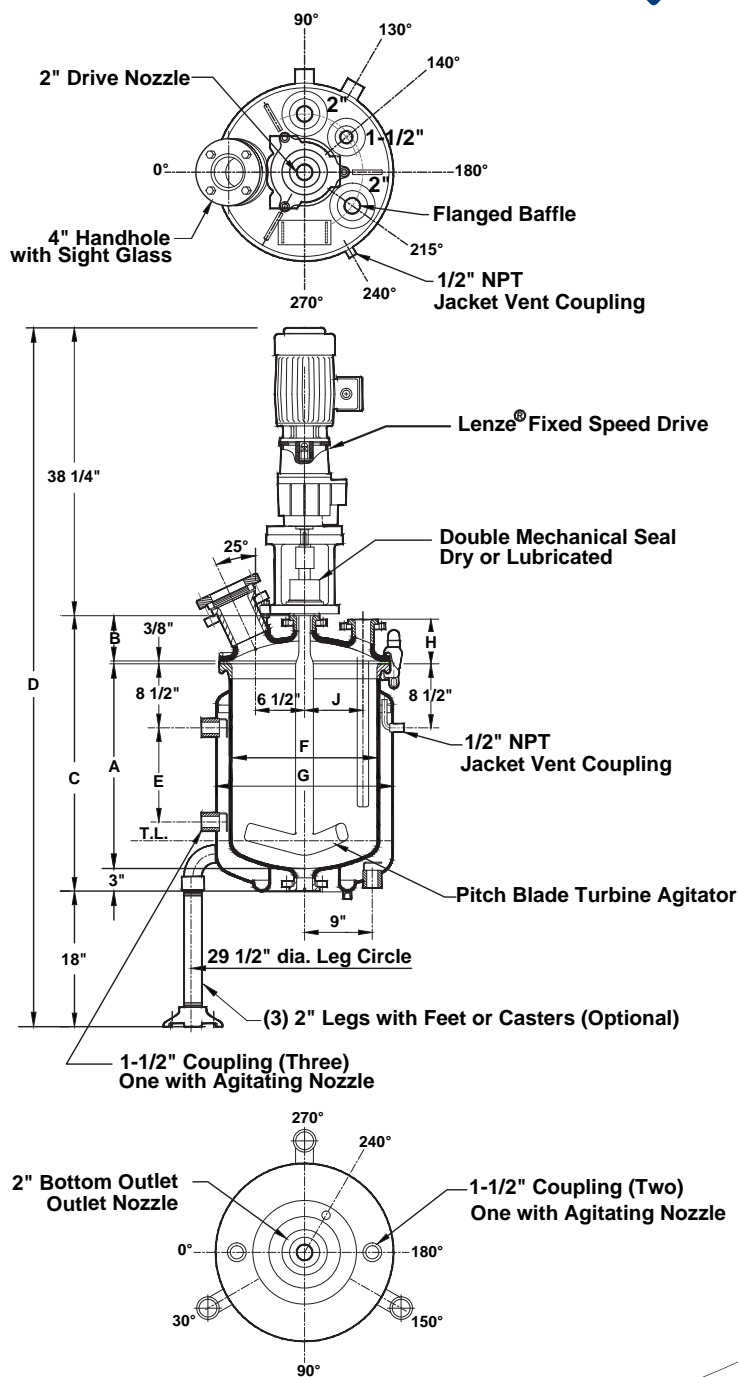

CTJ-50

50 GALLON JACKETED GLASS-LINED STEEL REACTOR

Specifications

| | |
|-------------------------------|----------------------------|
| Vessel Design Pressure (psig) | 150 and F.V. |
| Jacket Design Pressure (psig) | 125 or 110 w/ Int. F.V. |
| Design Temperature (°F) | 500 |
| Jacket Heating Area (sq. ft.) | 14 |

Dimensions (inches)

| | |
|-----------------------|---------|
| A | 28 |
| B | 6 1/2 |
| C | 37 7/8 |
| D | 94 5/8 |
| F (I.D.) | 22 7/8 |
| G (O.D.) | 27 9/16 |
| H (nozzle elevations) | |
| 1 1/2" | 5 1/2 |
| 2" | 6 |
| 3" | 6 |

Capacity (gallons)

| | |
|------------------------|------|
| Working | 50 |
| Total Volume | 50.5 |
| Head Volume | 5 |
| Per Inch Straight Side | 1.76 |
| Jacket | 17 |

Weight (pounds)

| | |
|------------------------------|-------|
| Bare Body (no accessories) | 920 |
| Complete (with drive system) | 1,400 |
| Add for Shipping | 150 |

Lenze® Helical Gear Drive

| | |
|-------------------|-----------------|
| Motor | 2HP |
| Motor Type | XP |
| Drive Size | GST06 2N VCR 5D |
| • Low Noise Level | |

Pitch Blade Turbine Agitator

| | |
|------------------------|---------|
| Span (inches) | 12 |
| Blade Angle | 45° |
| Speed (standard speed) | 175 RPM |
| • Clockwise Rotation | |

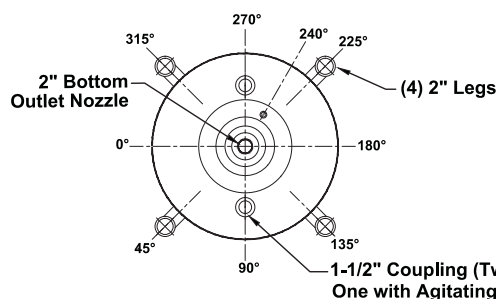
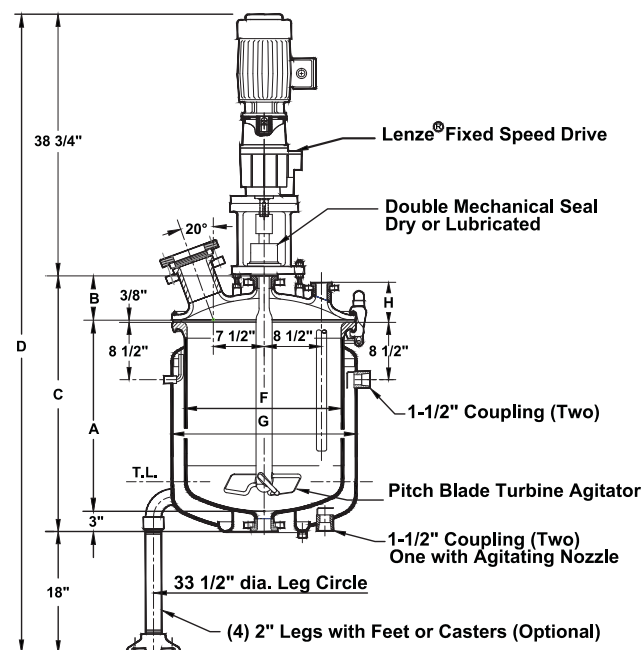
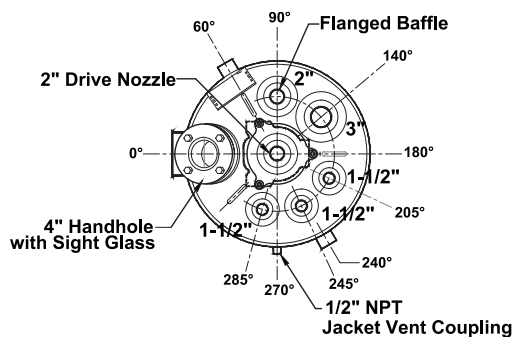

CTJ-50

50 GALLON JACKETED GLASS-LINED STEEL REACTOR

Specifications

| | |
|-------------------------------|----------------------------|
| Vessel Design Pressure (psig) | 150 and F.V. |
| Jacket Design Pressure (psig) | 125 or 100 w/ Int. F.V. |
| Design Temperature (°F) | 500 |
| Jacket Heating Area (sq. ft.) | 14 |

Dimensions (inches)

| | |
|-----------------------|---------|
| A | 28 |
| B | 6 1/2 |
| C | 37 7/8 |
| D | 94 5/8 |
| F (I.D.) | 22 7/8 |
| G (O.D.) | 27 9/16 |
| H (nozzle elevations) | |
| 1 1/2" | 5 1/2 |
| 2" | 6 |
| 3" | 6 |

Capacity (gallons)

| | |
|------------------------|------|
| Working | 50 |
| Total Volume | 50.5 |
| Head Volume | 5 |
| Per Inch Straight Side | 1.76 |
| Jacket | 17 |

Weight (pounds)

| | |
|------------------------------|-------|
| Bare Body (no accessories) | 920 |
| Complete (with drive system) | 1,400 |
| Add for Shipping | 150 |

Lenze® Helical Gear Drive

| | |
|-------------------|-----------------|
| Motor | 2HP |
| Motor Type | XP |
| Drive Size | GST06 2N VCR 5D |
| • Low Noise Level | |

Retreat Curve Impeller Agitator

| | |
|-----------------------------|---------|
| Span (inches) | 20 |
| Speed (standard speed) | 175 RPM |
| • Counterclockwise Rotation | |

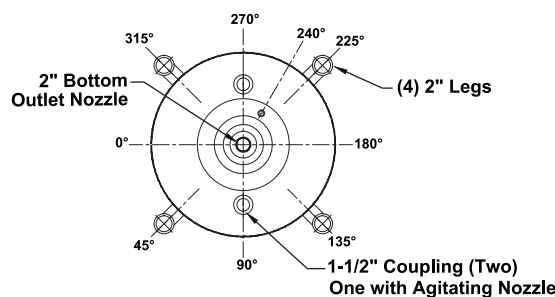
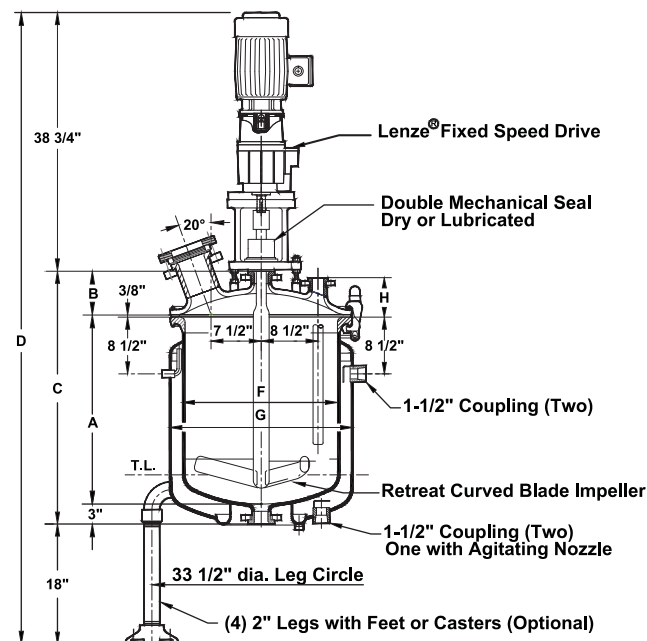
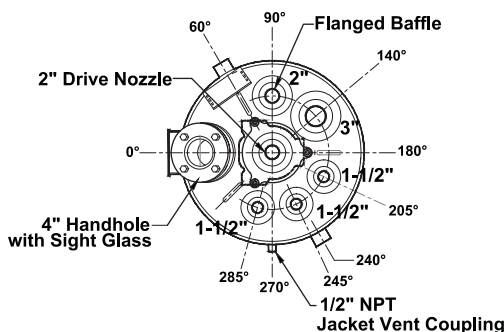

CTJ-100

100 GALLON JACKETED GLASS-LINED STEEL REACTOR

Specifications

| | |
|-------------------------------|----------------------------|
| Vessel Design Pressure (psig) | 150 and F.V. |
| Jacket Design Pressure (psig) | 115 or 100 w/ Int. F.V. |
| Design Temperature (°F) | 500 |
| Jacket Heating Area (sq. ft.) | 25.5 |

Dimensions (inches)

| | |
|-----------------------|---------------------------------|
| A | 36 ¹ / ₄ |
| B | 14 ¹ / ₂ |
| C | 54 ⁵ / ₈ |
| D | 122 ⁵ / ₈ |
| F (I.D.) | 32 |
| G (O.D.) | 37 ³ / ₈ |
| H (nozzle elevations) | 4" |
| 4" | 14 |

Capacity (gallons)

| | |
|------------------------|-------|
| Working | 100 |
| Total Volume | 145.5 |
| Head Volume | 18.5 |
| Per Inch Straight Side | 3.5 |

Weight (pounds)

| | |
|------------------------------|-------|
| Bare Body (no accessories) | 1,550 |
| Complete (with drive system) | 2,060 |
| Add for Shipping | 400 |

Lenze® Helical Gear Drive

| | |
|-------------------|-----------------|
| Motor | 3HP |
| Motor Type | XP |
| Drive Size | GST07 2D VCR 5E |
| • Low Noise Level | |

Pitch Blade Turbine Agitator

| | |
|------------------------|---------------|
| Span (inches) | 16 |
| Blade Angle | 45° |
| Speed (standard speed) | 27 to 156 RPM |
| • Clockwise Rotation | |

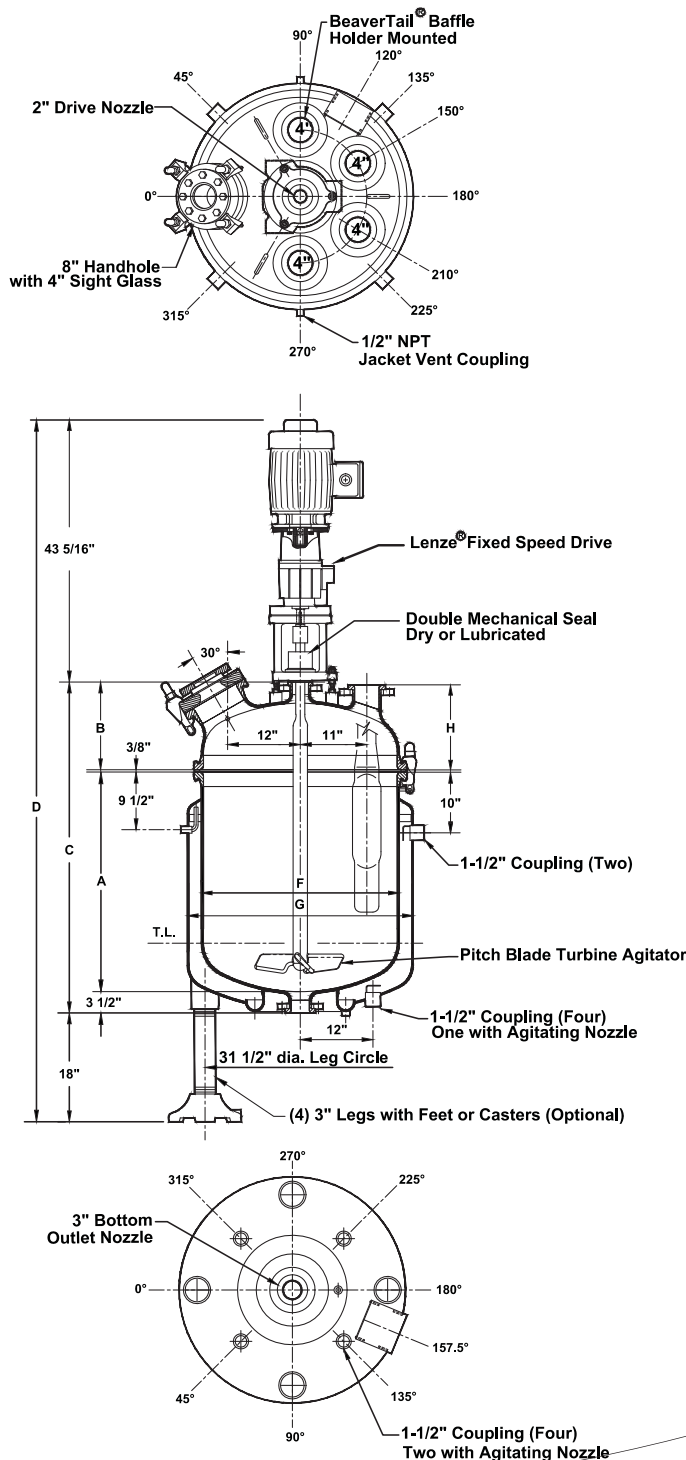

CTJ-100

100 GALLON JACKETED GLASS-LINED STEEL REACTOR

Specifications

| | |
|-------------------------------|----------------------------|
| Vessel Design Pressure (psig) | 150 and F.V. |
| Jacket Design Pressure (psig) | 115 or 100 w/ Int. F.V. |
| Design Temperature (°F) | 500 |
| Jacket Heating Area (sq. ft.) | 25.5 |

Dimensions (inches)

| | |
|-----------------------|-----------------------------------|
| A | 36 ¹ / ₄ |
| B | 14 ¹ / ₂ |
| C | 54 ⁵ / ₈ |
| D | 115 ¹⁵ / ₁₆ |
| F (I.D.) | 32 |
| G (O.D.) | 37 ³ / ₈ |
| H (nozzle elevations) | |
| 4" | 14 |

Capacity (gallons)

| | |
|------------------------|-------|
| Working | 100 |
| Total Volume | 145.5 |
| Head Volume | 18.5 |
| Per Inch Straight Side | 3.5 |
| Jacket | 32 |

Weight (pounds)

| | |
|------------------------------|-------|
| Bare Body (no accessories) | 1,550 |
| Complete (with drive system) | 2,060 |
| Add for Shipping | 400 |

Lenze® Helical Gear Drive

| | |
|-------------------|-----------------|
| Motor | 3HP |
| Motor Type | XP |
| Drive Size | GST06 2N VCR 5E |
| • Low Noise Level | |

Retreat Curve Impeller Agitator

| | |
|-----------------------------|---------|
| Span (inches) | 24 |
| Speed (standard speed) | 139 RPM |
| • Counterclockwise Rotation | |

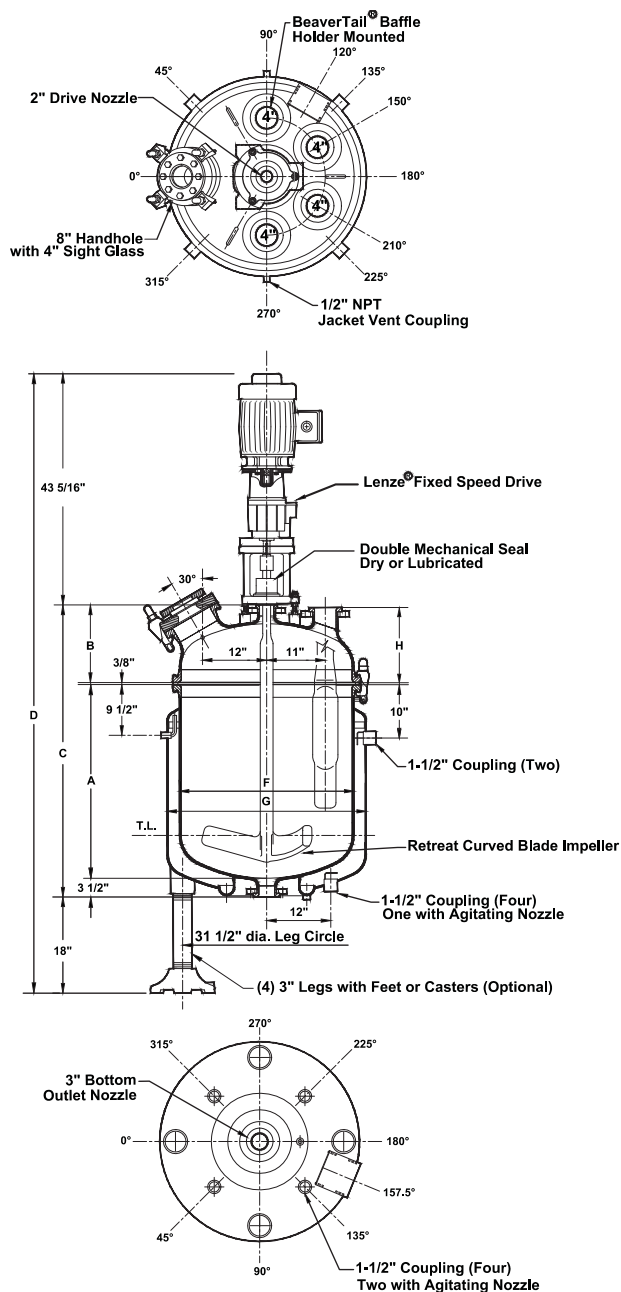

CTJ-300

300 GALLON JACKETED GLASS-LINED STEEL REACTOR

Specifications

| | |
|-------------------------------|---------------------------|
| Vessel Design Pressure (psig) | 90 and F.V. |
| Jacket Design Pressure (psig) | 105 or 90 w/ Int. F.V. |
| Design Temperature (°F) | 500 |
| Jacket Heating Area (sq. ft.) | 54.6 |

Dimensions (inches)

| | |
|-----------------------|---------|
| A | 49 1/4 |
| B | 15 1/2 |
| C | 65 1/8 |
| D | 127 1/2 |
| F (I.D.) | 48 |
| G (O.D.) | 53 1/8 |
| H (nozzle elevations) | |
| 4" nozzle | 14 |
| 8" nozzle | 15 |
| J (nozzle radius) | |
| 4" nozzle | 18 |
| 8" nozzle | 18 |

Capacity (gallons)

| | |
|------------------------|-----|
| Working | 300 |
| Total Volume | 450 |
| Head Volume | 48 |
| Per Inch Straight Side | 7.8 |

Weight (pounds)

| | |
|------------------------------|-------|
| Bare Body (no accessories) | 4,325 |
| Complete (with drive system) | 4,980 |
| Add for Shipping | 500 |

Series 60 Drive

| | |
|------------|-------|
| Motor | 5HP |
| Motor Type | XP |
| Drive Size | 61Q06 |

- Three Year Warranty
- Low Noise Level
- Helical Gearing

Pitch Blade Turbine or Retreat Curve Impeller Agitator

| | |
|------------------------|--|
| Speed (standard speed) | 125 RPM |
| • | Clockwise or Counterclockwise Rotation |

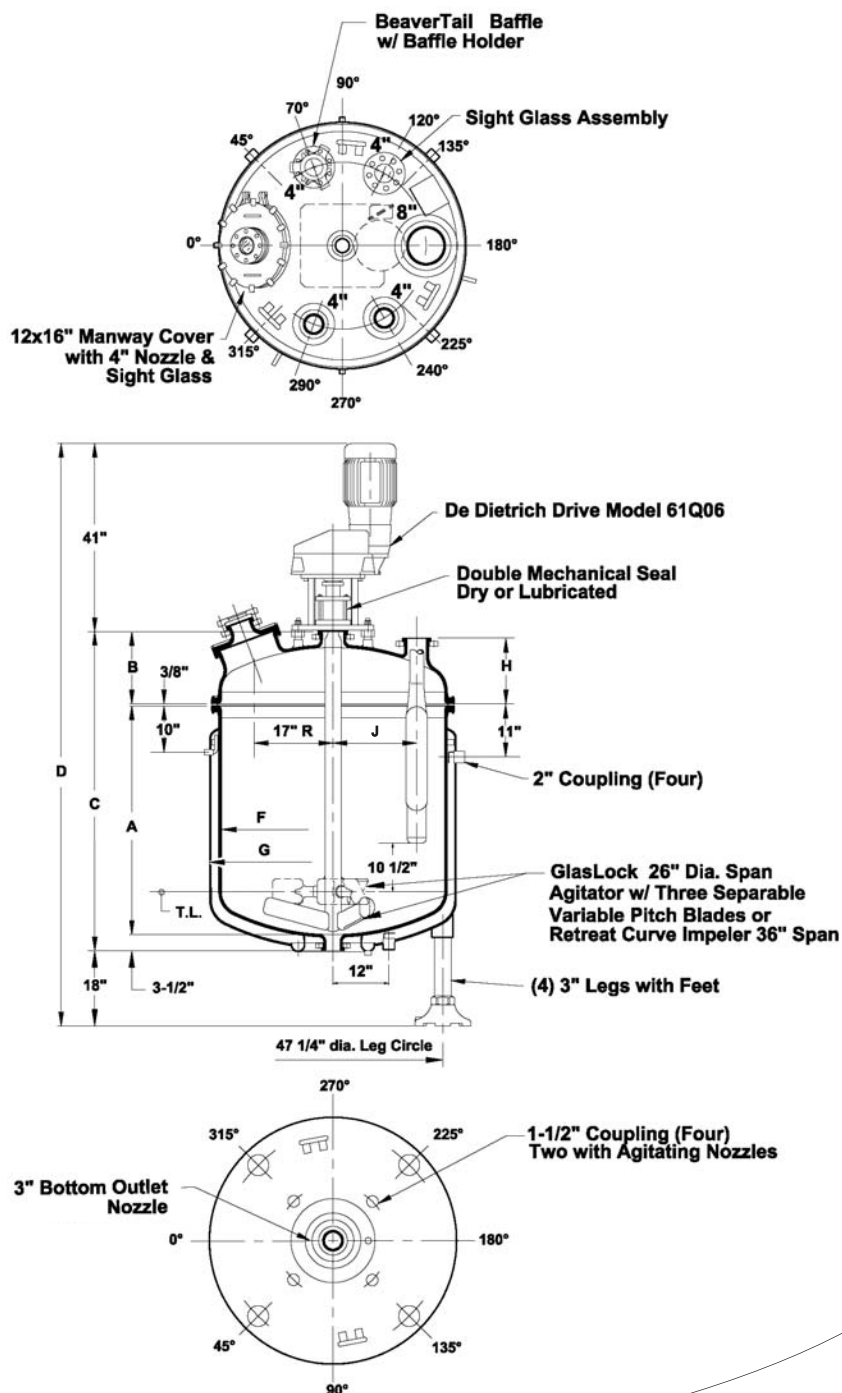

CTJ-48-500

500 GALLON JACKETED GLASS-LINED STEEL REACTOR

Specifications

| | |
|-------------------------------|---------------------------|
| Vessel Design Pressure (psig) | 90 and F.V. |
| Jacket Design Pressure (psig) | 105 or 90 w/ Int. F.V. |
| Design Temperature (°F) | 500 |
| Jacket Heating Area (sq. ft.) | 90 |

Dimensions (inches)

| | |
|-----------------------|---------|
| A | 76 |
| B | 15 1/2 |
| C | 21 7/8 |
| D | 150 7/8 |
| F (I.D.) | 48 |
| G (O.D.) | 53 1/8 |
| H (nozzle elevations) | |
| 4" nozzles | 14 |
| 8" nozzle | 15 |
| J (nozzle radius) | |
| 4" nozzles | 18 |
| 8" nozzle | 18 |

Capacity (gallons)

| | |
|------------------------|-----|
| Working | 500 |
| Total Volume | 615 |
| Head Volume | 48 |
| Per Inch Straight Side | 7.8 |

Weight (pounds)

| | |
|------------------------------|-------|
| Bare Body (no accessories) | 5,200 |
| Complete (with drive system) | 6,380 |
| Add for Shipping | 500 |

Series 60 Drive

| | |
|------------|-------|
| Motor | 5HP |
| Motor Type | XP |
| Drive Size | 61Q06 |

- Three Year Warranty
- Low Noise Level
- Helical Gearing

Pitch Blade Turbine or Retreat Curve Impeller Agitator

| | |
|------------------------|--|
| Speed (standard speed) | 100RPM |
| • | Clockwise or Counterclockwise Rotation |

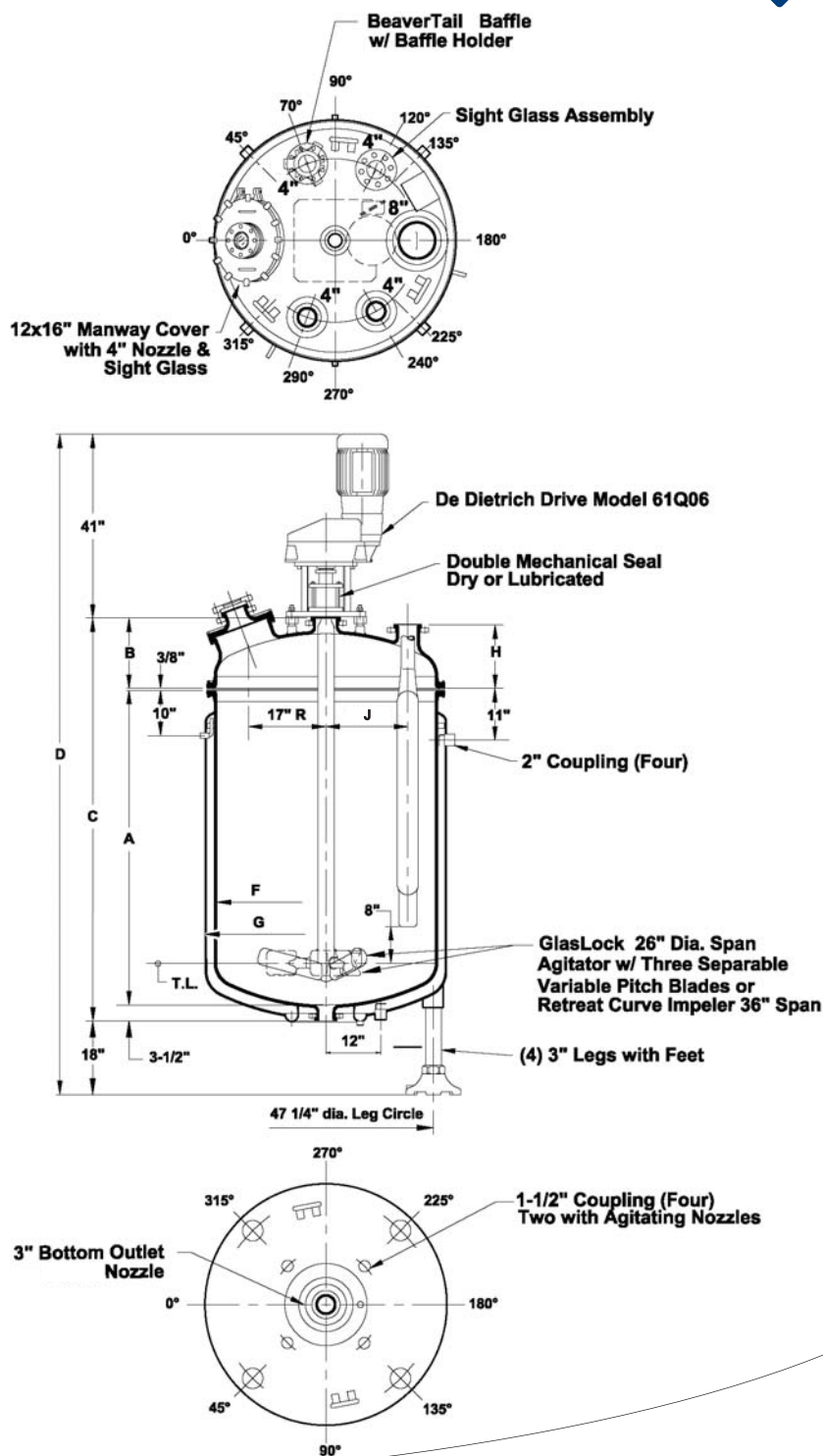

De Dietrich Process Systems, Inc.

244 Sheffield Street
Mountainside, NJ 07092

P 908.317.2585
F 908.889.4960

www.ddpsinc.com
sales@ddpsinc.com

CTJ-54-500

500 GALLON JACKETED GLASS-LINED STEEL REACTOR

Specifications

| | |
|-------------------------------|---------------------------|
| Vessel Design Pressure (psig) | 90 and F.V. |
| Jacket Design Pressure (psig) | 105 or 90 w/ Int. F.V. |
| Design Temperature (°F) | 500 |
| Jacket Heating Area (sq. ft.) | 81.5 |

Dimensions (inches)

| | |
|-----------------------|---------------------------------|
| A | 64 ¹ / ₄ |
| B | 13 ¹ / ₈ |
| C | 84 ³ / ₄ |
| D | 143 ³ / ₄ |
| F (I.D.) | 53 ³ / ₄ |
| G (O.D.) | 61 |
| H (nozzle elevations) | |
| 4" nozzles | 14 |
| 8" nozzle | 17 |
| J (nozzle radius) | |
| 4" nozzles | 21 |
| 8" nozzle | 21 |

Capacity (gallons)

| | |
|------------------------|-----|
| Working | 500 |
| Total Volume | 718 |
| Head Volume | 67 |
| Per Inch Straight Side | 9.8 |

Weight (pounds)

| | |
|------------------------------|-------|
| Bare Body (no accessories) | 5,890 |
| Complete (with drive system) | 7,070 |
| Add for Shipping | 500 |

Series 60 Drive

| | |
|------------|-------|
| Motor | 5HP |
| Motor Type | XP |
| Drive Size | 61Q06 |

- Three Year Warranty
- Low Noise Level
- Helical Gearing

Pitch Blade Turbine or Retreat Curve Impeller Agitator

| | |
|------------------------|--|
| Speed (standard speed) | 100RPM |
| • | Clockwise or Counterclockwise Rotation |

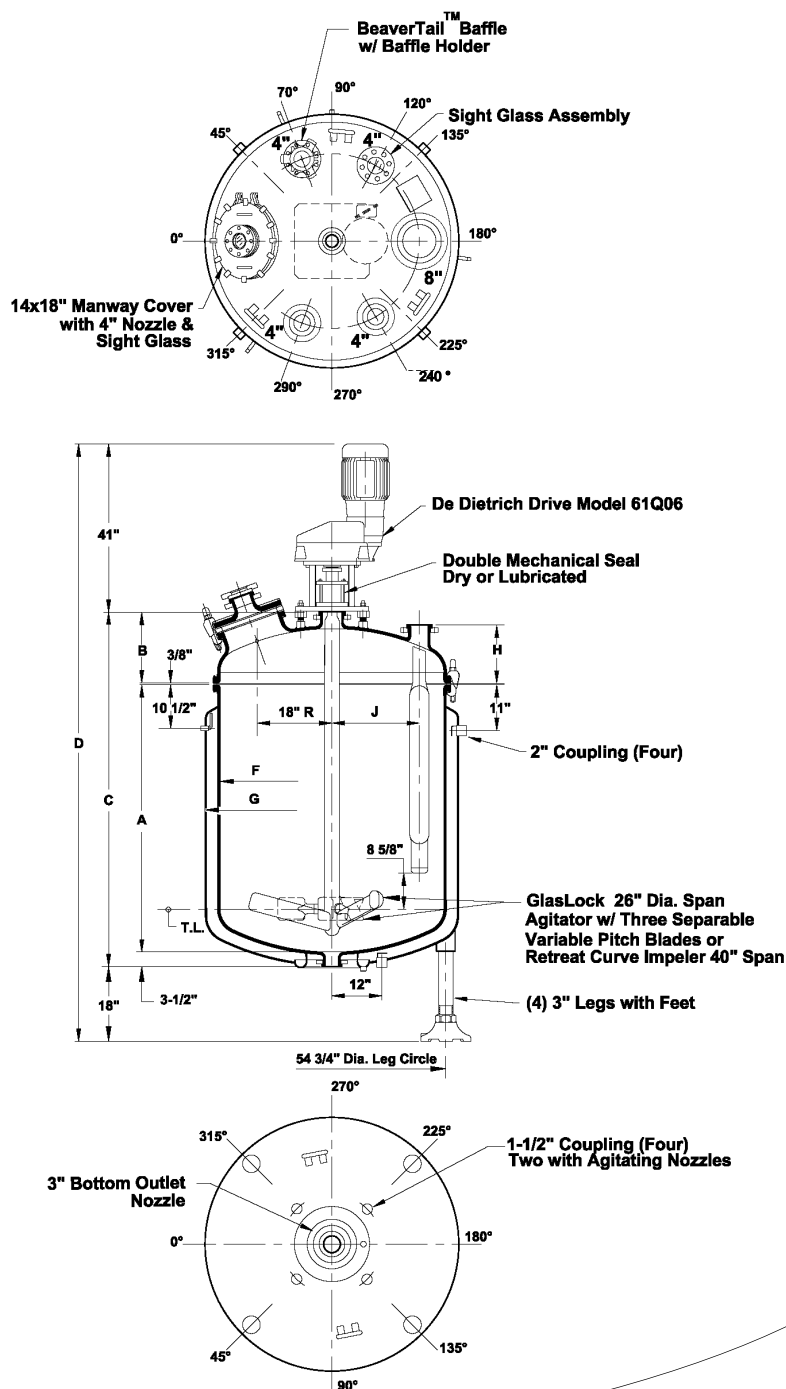

CTJ-60-500

500 GALLON JACKETED GLASS-LINED STEEL REACTOR

Specifications

| | |
|-------------------------------|---------------------------|
| Vessel Design Pressure (psig) | 90 and F.V. |
| Jacket Design Pressure (psig) | 105 or 90 w/ Int. F.V. |
| Design Temperature (°F) | 500 |
| Jacket Heating Area (sq. ft.) | 75.5 |

Dimensions (inches)

| | |
|-----------------------|----------|
| A | 52 1/4 |
| B | 17 3/4 |
| C | 73 3/4 |
| D | 132 3/4 |
| F (I.D.) | 59 5/8 |
| G (O.D.) | 66 15/16 |
| H (nozzle elevations) | |
| 4" nozzles | 15 |
| 8" nozzle | 16 |
| J (nozzle radius) | |
| 4" nozzles | 22 |
| 8" nozzle | 22 |

Capacity (gallons)

| | |
|------------------------|-----|
| Working | 500 |
| Total Volume | 718 |
| Head Volume | 91 |
| Per Inch Straight Side | 12 |

Weight (pounds)

| | |
|------------------------------|-------|
| Bare Body (no accessories) | 6,600 |
| Complete (with drive system) | 7,900 |
| Add for Shipping | 500 |

Series 60 Drive

| | |
|------------|-------|
| Motor | 5HP |
| Motor Type | XP |
| Drive Size | 61Q06 |

- Three Year Warranty
- Low Noise Level
- Helical Gearing

Pitch Blade Turbine or Retreat Curve Impeller Agitator

| | |
|------------------------|--|
| Speed (standard speed) | 100RPM |
| • | Clockwise or Counterclockwise Rotation |

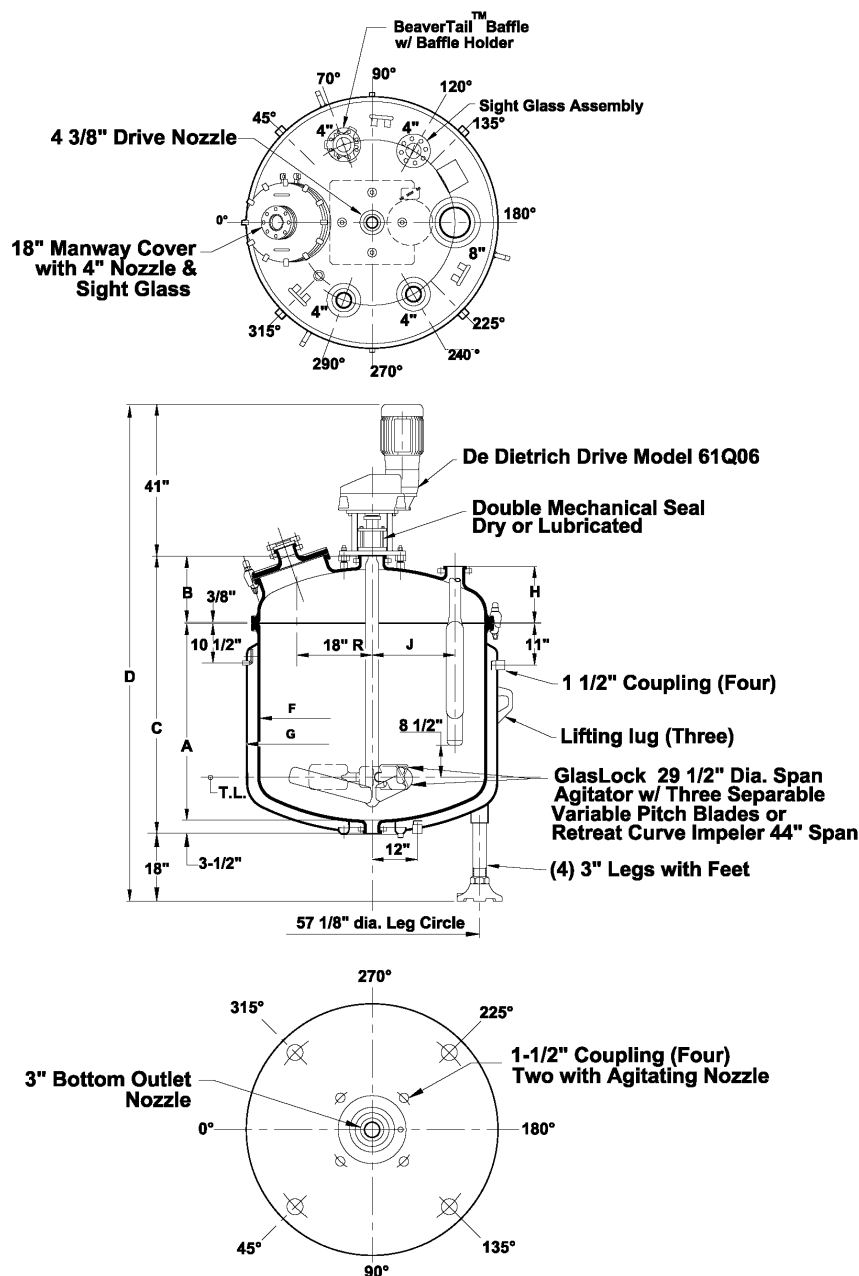

CTJ-750

750 GALLON JACKETED GLASS-LINED STEEL REACTOR

Specifications

| | |
|-------------------------------|---------------------------|
| Vessel Design Pressure (psig) | 75 and F.V. |
| Jacket Design Pressure (psig) | 105 or 90 w/ Int. F.V. |
| Design Temperature (°F) | 500 |
| Jacket Heating Area (sq. ft.) | 107.5 |

Dimensions (inches)

| | |
|-----------------------|----------|
| A | 76 1/4 |
| B | 17 3/4 |
| C | 97 3/4 |
| D | 156 3/4 |
| F (I.D.) | 59 5/8 |
| G (O.D.) | 66 15/16 |
| H (nozzle elevations) | |
| 4" nozzles | 15 |
| 8" nozzle | 16 |
| J (nozzle radius) | |
| 4" nozzles | 15 |
| 8" nozzle | 16 |

Capacity (gallons)

| | |
|------------------------|-----|
| Working | 750 |
| Total Volume | 991 |
| Head Volume | 91 |
| Per Inch Straight Side | 12 |

Weight (pounds)

| | |
|------------------------------|-------|
| Bare Body (no accessories) | 8,140 |
| Complete (with drive system) | 9,445 |
| Add for Shipping | 500 |

Series 60 Drive

| | |
|------------|----------|
| Motor | 7 1/2 HP |
| Motor Type | XP |
| Drive Size | 61Q06 |

- Three Year Warranty
- Low Noise Level
- Helical Gearing

Pitch Blade Turbine or Retreat Curve Impeller Agitator

| | |
|------------------------|--|
| Speed (standard speed) | 100RPM |
| • | Clockwise or Counterclockwise Rotation |

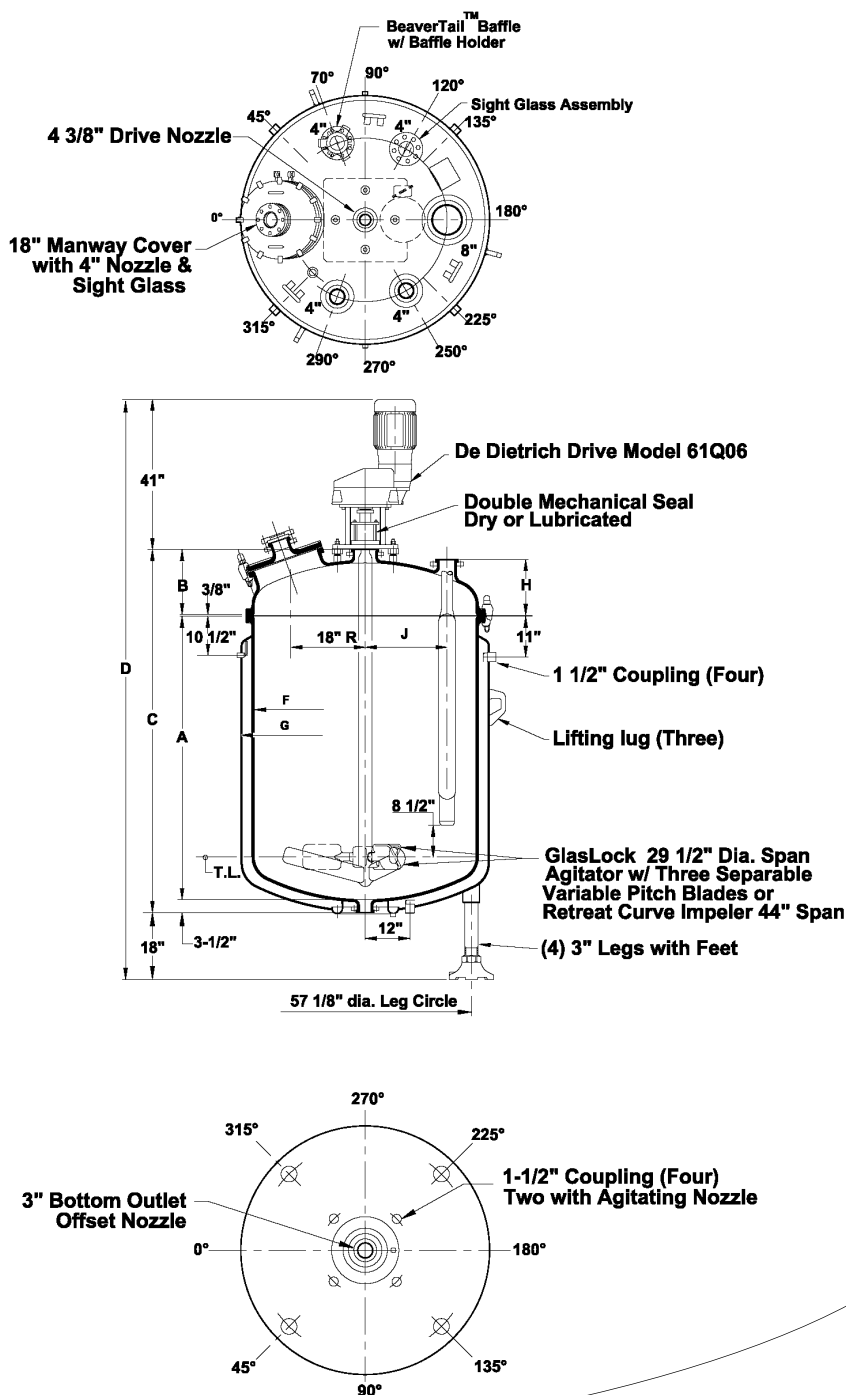

CTJ-1000

1,000 GALLON JACKETED GLASS-LINED STEEL REACTOR

Specifications

| | |
|-------------------------------|---------------------------|
| Vessel Design Pressure (psig) | 75 and F.V. |
| Jacket Design Pressure (psig) | 105 or 90 w/ Int. F.V. |
| Design Temperature (°F) | 500 |
| Jacket Heating Area (sq. ft.) | 128 |

Dimensions (inches)

| | |
|-----------------------|----------------------------------|
| A | 82 ³ / ₄ |
| B | 21 |
| C | 107 ¹ / ₂ |
| D | 172 ¹ / ₂ |
| F (I.D.) | 66 |
| G (O.D.) | 72 ²⁷ / ₃₂ |
| H (nozzle elevations) | |
| 4" nozzles | 17 |
| 8" nozzle | 18 |
| J (nozzle radius) | |
| 4" nozzles | 24 |
| 8" nozzle | 24 |

Capacity (gallons)

| | |
|------------------------|------|
| Working | 1000 |
| Total Volume | 1313 |
| Head Volume | 124 |
| Per Inch Straight Side | 15 |

Weight (pounds)

| | |
|------------------------------|--------|
| Bare Body (no accessories) | 9,725 |
| Complete (with drive system) | 11,300 |
| Add for Shipping | 700 |

Series 60 Drive

| | |
|------------|-------|
| Motor | 10HP |
| Motor Type | XP |
| Drive Size | 62Q08 |

- Three Year Warranty
- Low Noise Level
- Helical Gearing

Pitch Blade Turbine or Retreat Curve Impeller Agitator

| | |
|------------------------|--|
| Speed (standard speed) | 100RPM |
| • | Clockwise or Counterclockwise Rotation |

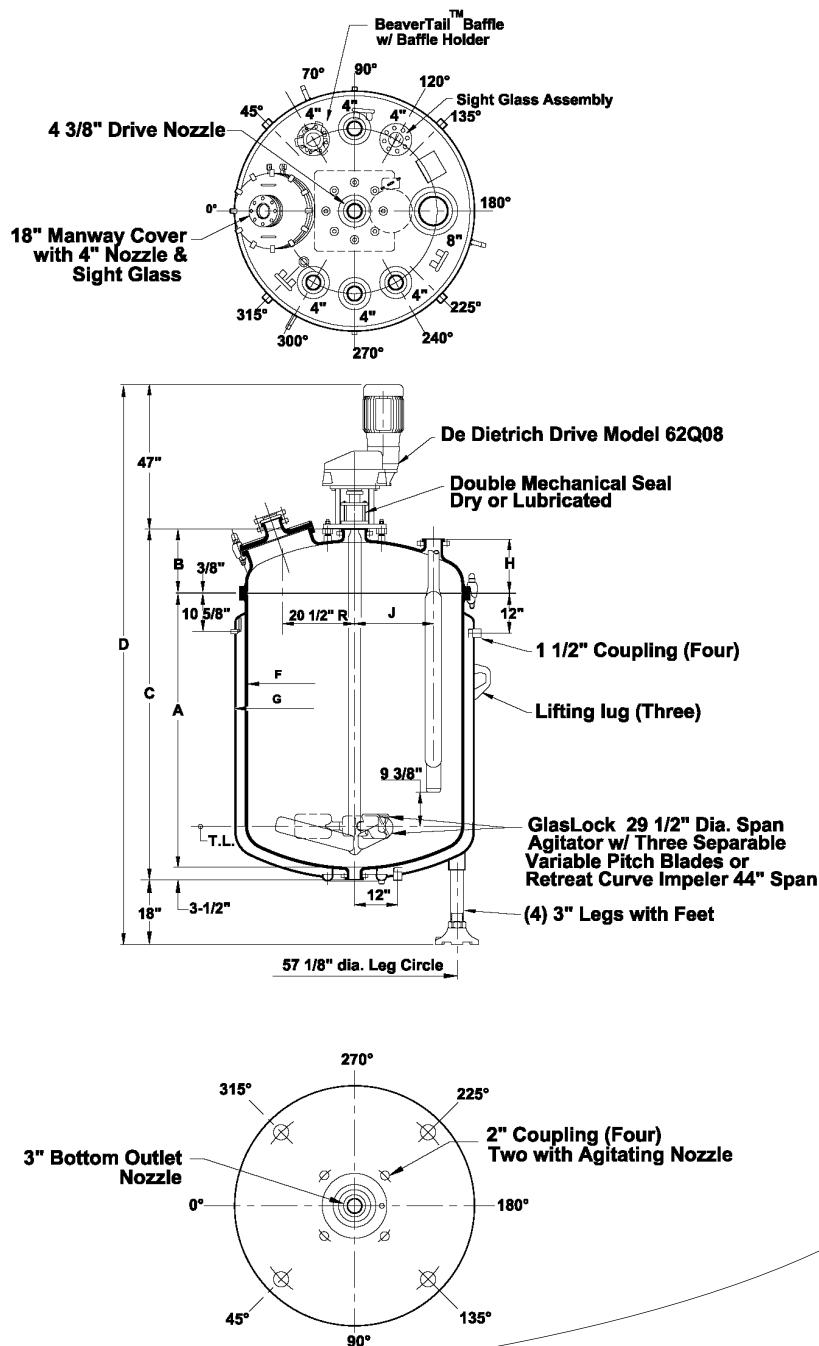

CTJ-2000

2,000 GALLON JACKETED GLASS-LINED STEEL REACTOR

Specifications

| | |
|-------------------------------|---------------------------|
| Vessel Design Pressure (psig) | 90 and F.V. |
| Jacket Design Pressure (psig) | 100 or 85 w/ Int. F.V. |
| Design Temperature (°F) | 500 |
| Jacket Heating Area (sq. ft.) | 201 |

Dimensions (inches)

| | |
|-----------------------|---------------------------------|
| A | 100 ³ / ₄ |
| B | 25 |
| C | 130 |
| D | 201 |
| F (I.D.) | 82 ³ / ₄ |
| G (O.D.) | 90 ⁹ / ₁₆ |
| H (nozzle elevations) | |
| 4" nozzles | 20 |
| 6" nozzles | 20 |
| 8" nozzle | 20 |
| J (nozzle radius) | |
| 4" nozzles | 34 |
| 6" nozzles | 34 |
| 8" nozzle | 34 |

Capacity (gallons)

| | |
|------------------------|-------|
| Working | 2,000 |
| Total Volume | 2,599 |
| Head Volume | 245 |
| Per Inch Straight Side | 23 |

Weight (pounds)

| | |
|------------------------------|--------|
| Bare Body (no accessories) | 16,940 |
| Complete (with drive system) | 18,760 |
| Add for Shipping | 1,000 |

Series 60 Drive

| | |
|------------|-------|
| Motor | 15HP |
| Motor Type | XP |
| Drive Size | 63Q10 |

- Three Year Warranty
- Low Noise Level
- Helical Gearing

Pitch Blade Turbine or Retreat Curve Impeller Agitator

| | |
|------------------------|--|
| Speed (standard speed) | 100RPM |
| • | Clockwise or Counterclockwise Rotation |

