



### Nozzle Schedule

Mark	Size	Rating	Type	Service
A	4"	ASME	Ferrule	Sight Glass
B	1 1/2"	ASME	Ferrule	Pressure Gauge
C	2"	ASME	Ferrule	Product Inlet
D	1"x3"	ASME	Ferrule	Spray Disc
E	1 1/2"	ASME	Ferrule	Filtrate Outlet
F	2"	ASME	Ferrule	Vent
G	1"	ASME	Ferrule	Nitrogen Pressure
H	1"	150#	RFSO	Steam In
J	1"	150#	RSSO	Steam Out

### Design Data

	Shell	Jacket/Tube
Design Pressure (PSIG)	50/-15	100
Design Temperature (°F)	250	250
M.A.W.P. (PSIG)	50/-15	100
M.D.M.T. (°F)	-20	-20
Radiographic Examination	None	None
Join Efficiency (%)	0.7	0.7

Filter Area	0.07m <sup>2</sup>
Nominal Diameter	12"
Working Volume	30L

### Weight (lbs.)

Erection (shipping) weight	125
Weight, full of water	195

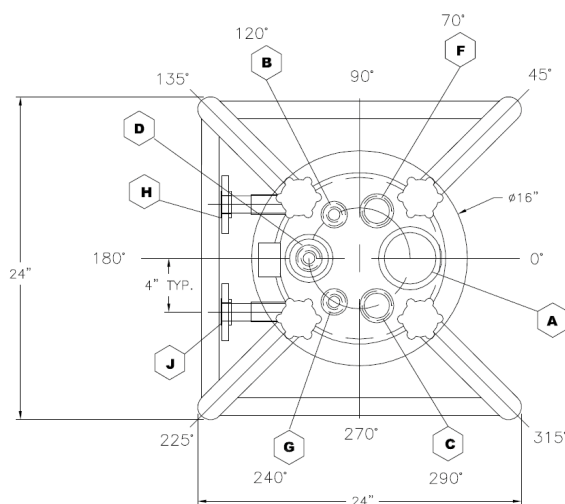

PLAN VIEW  
(SHOWS TRUE ORIENTATION)

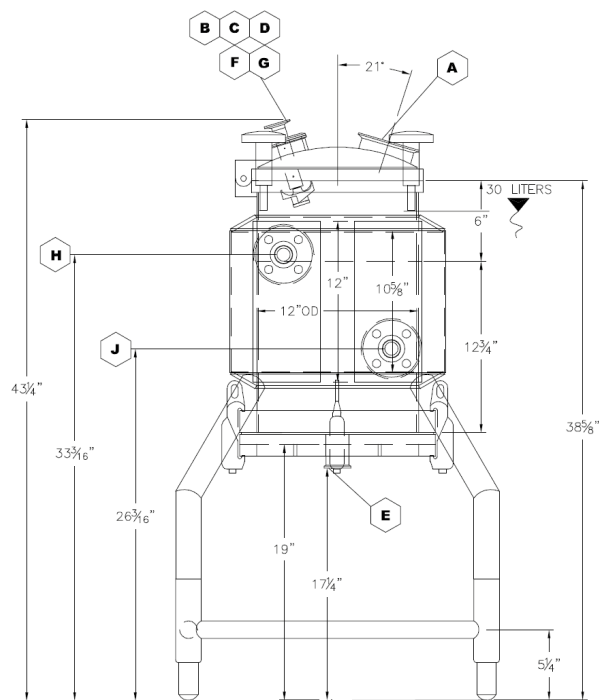

ELEVATION VIEW



**ROSENMUND**

**ROMAN FILTER  
12-30L**

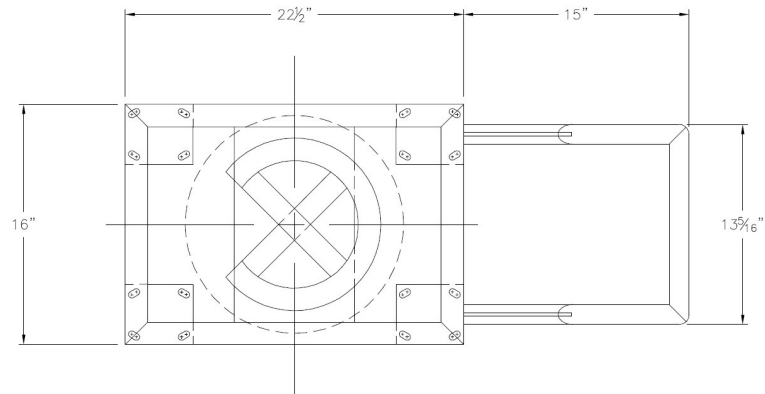

CART PLAN VIEW  
(SHOWS TRUE ORIENTATION)

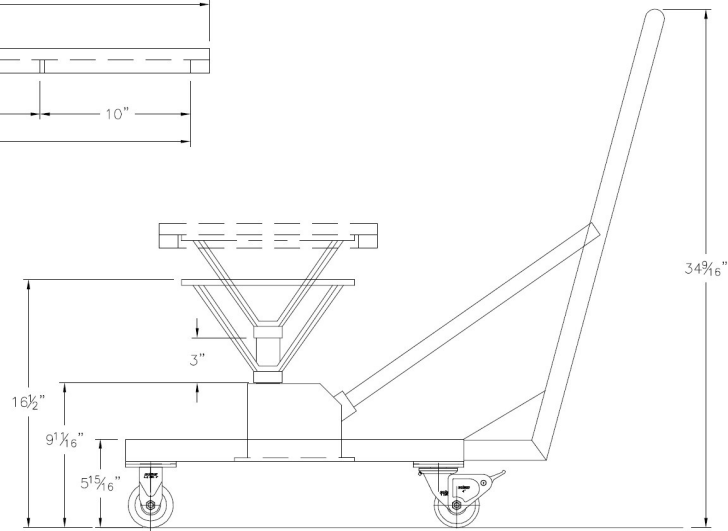
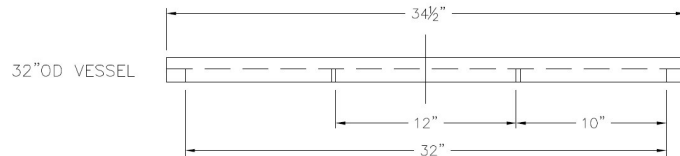
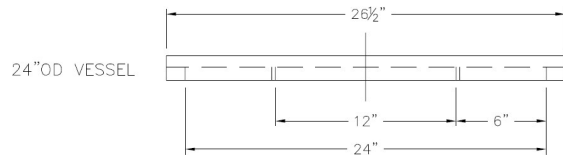
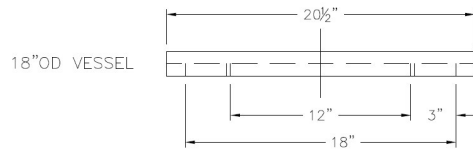
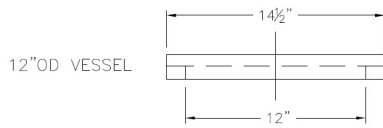

CART ELEVATION VIEW

**De Dietrich Process Systems, Inc.**

244 Sheffield Street  
Mountainside, NJ 07092

P 908.317.2585  
F 908.889.4960

[www.ddpsinc.com](http://www.ddpsinc.com)  
[sales@ddpsinc.com](mailto:sales@ddpsinc.com)





### Nozzle Schedule

Mark	Size	Rating	Type	Service
A	4"	ASME	Ferrule	Sight Glass
B	2"	ASME	Ferrule	Pressure Gauge
C	2"	ASME	Ferrule	Product Inlet
D	1"x3"	ASME	Ferrule	Spray Disc
E	1 1/2"	ASME	Ferrule	Filtrate Outlet
F	2"	ASME	Ferrule	Vent
G	1"	ASME	Ferrule	Nitrogen Pressure
H	1"	150#	RFSO	Steam In
J	1"	150#	RSSO	Steam Out

### Design Data

	Shell	Jacket/Tube
Design Pressure (PSIG)	50/-15	100
Design Temperature (°F)	250	250
M.A.W.P. (PSIG)	50/-15	100
M.D.M.T. (°F)	-20	-20
Radiographic Examination	None	None
Join Efficiency (%)	0.7	0.7

Filter Area	0.16m <sup>2</sup>
Nominal Diameter	18"
Working Volume	70L

### Weight (lbs.)

Erection (shipping) weight	225
Weight, full of water	420

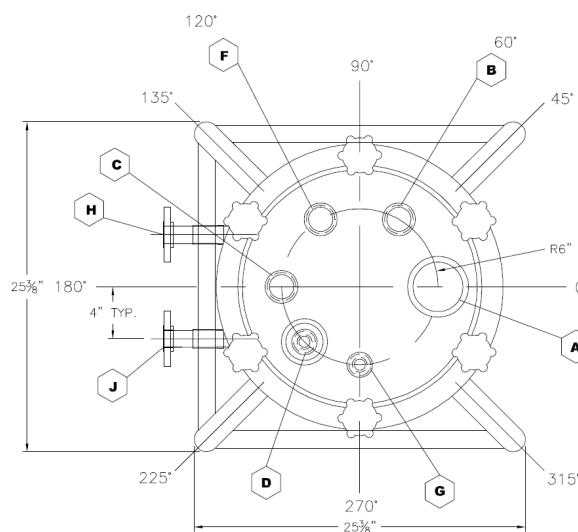

PLAN VIEW  
(SHOWS TRUE ORIENTATION)

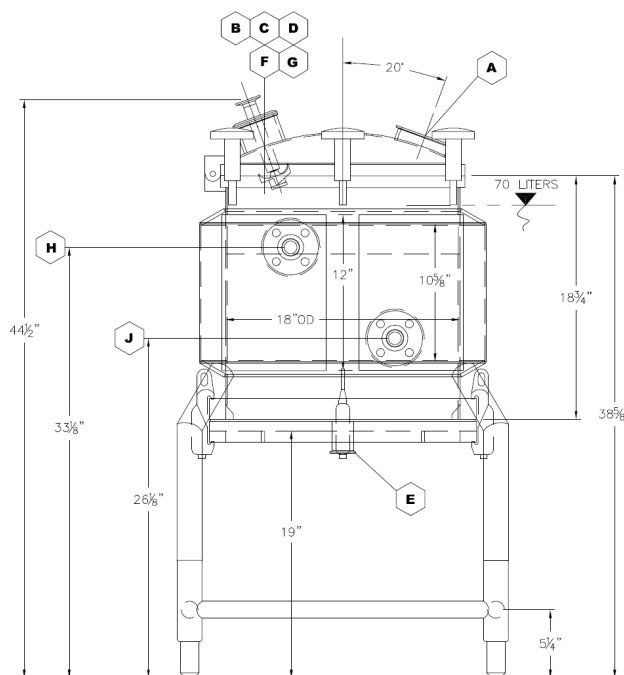

ELEVATION VIEW



**ROSENMUND**

**ROMAN FILTER  
18-70L**

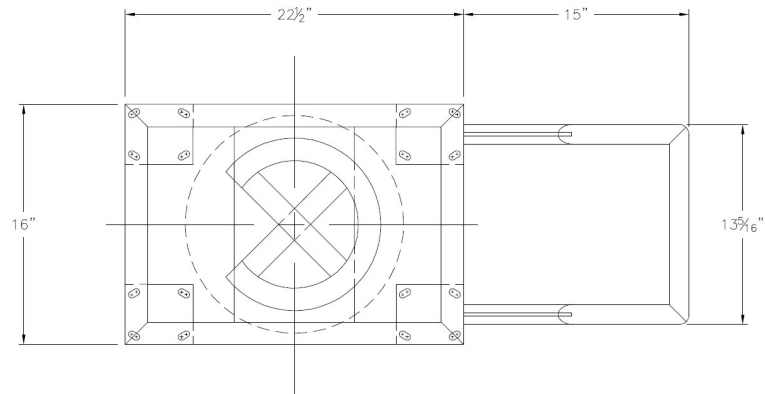

CART PLAN VIEW  
(SHOWS TRUE ORIENTATION)

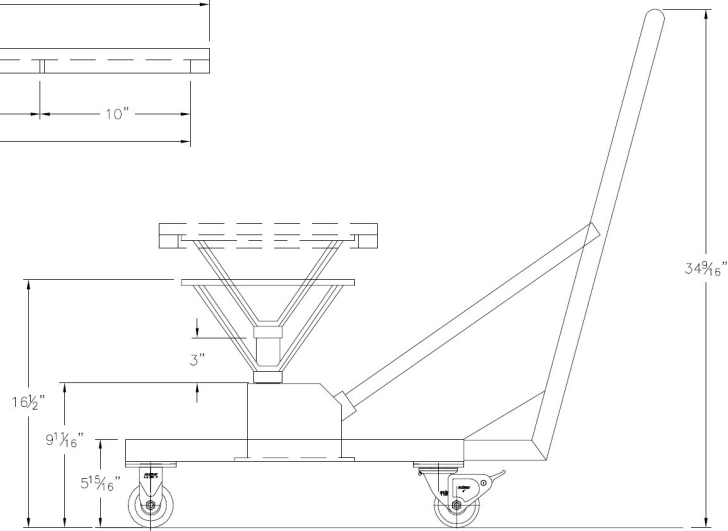
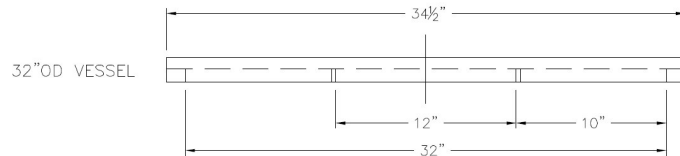
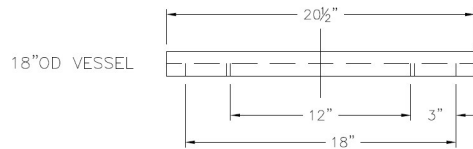
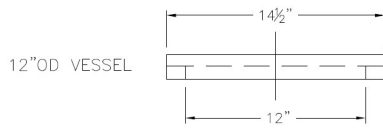

CART ELEVATION VIEW

**De Dietrich Process Systems, Inc.**

244 Sheffield Street  
Mountainside, NJ 07092

P 908.317.2585  
F 908.889.4960

[www.ddpsinc.com](http://www.ddpsinc.com)  
[sales@ddpsinc.com](mailto:sales@ddpsinc.com)





### Nozzle Schedule

Mark	Size	Rating	Type	Service
A	4"	ASME	Ferrule	Sight Glass
B	2"	ASME	Ferrule	Pressure Gauge
C	2"	ASME	Ferrule	Product Inlet
D	1"x3"	ASME	Ferrule	Spray Disc
E	1 1/2"	ASME	Ferrule	Filtrate Outlet
F	2"	ASME	Ferrule	Vent
G	1"	ASME	Ferrule	Nitrogen Pressure
H	1"	150#	RFSO	Steam In
J	1"	150#	RSSO	Steam Out

### Design Data

	Shell	Jacket/Tube
Design Pressure (PSIG)	50/-15	100
Design Temperature (°F)	250	250
M.A.W.P. (PSIG)	50/-15	100
M.D.M.T. (°F)	-20	-20
Radiographic Examination	None	None
Join Efficiency (%)	0.7	0.7

Filter Area	0.29m <sup>2</sup>
Nominal Diameter	24"
Working Volume	125L

### Weight (lbs.)

Erection (shipping) weight	410
Weight, full of water	565

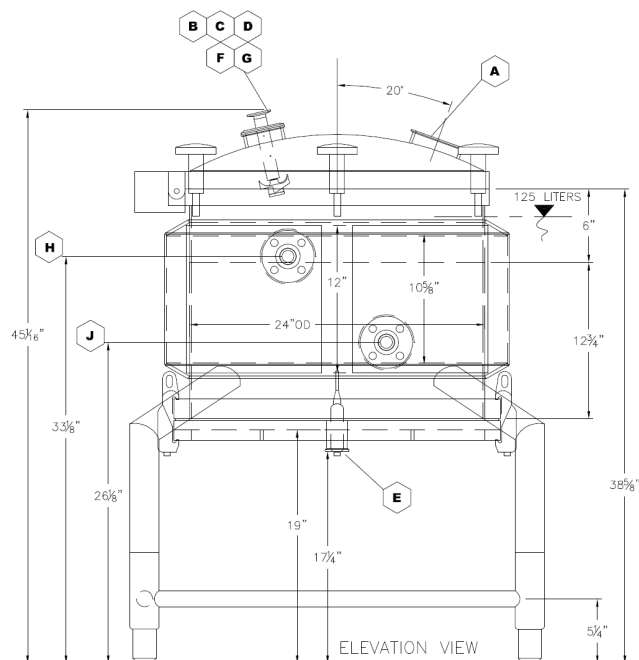
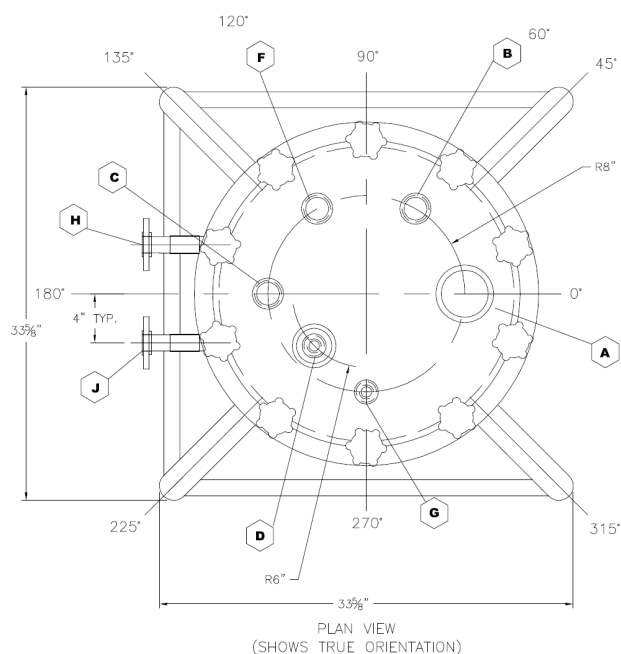



**ROSENMUND**

**ROMAN FILTER  
24-125L**

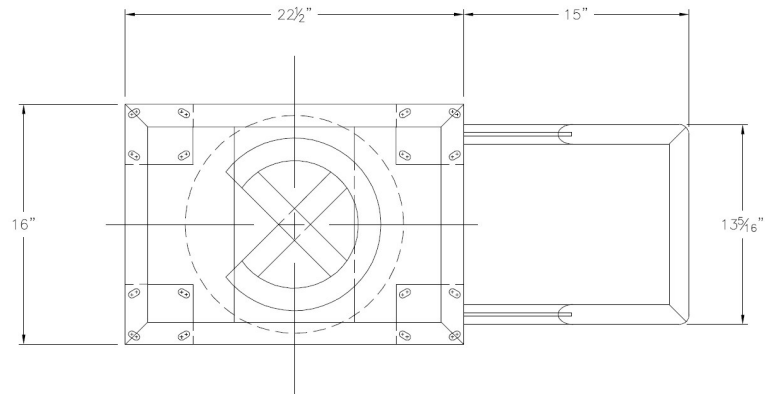

CART PLAN VIEW  
(SHOWS TRUE ORIENTATION)

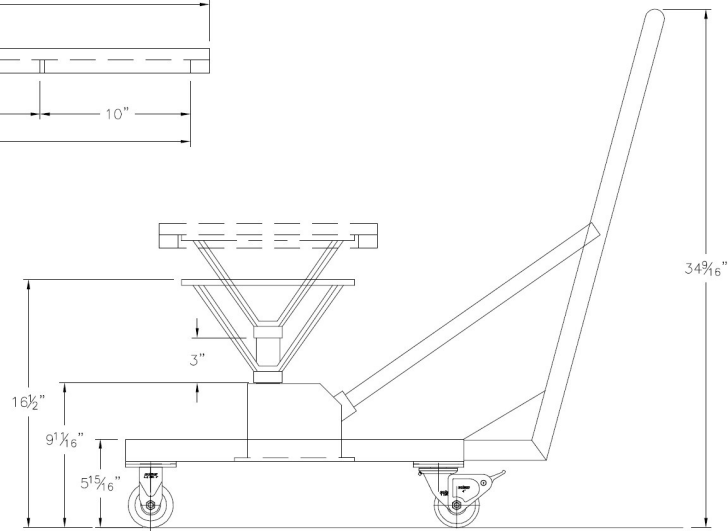
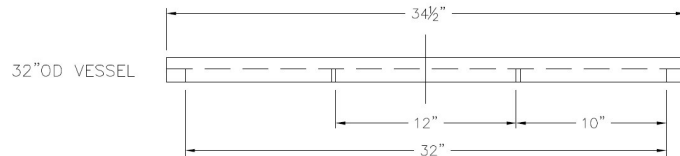
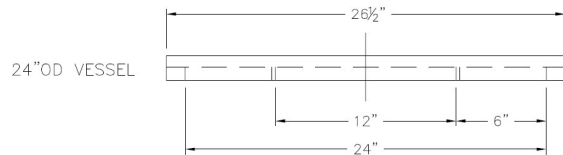
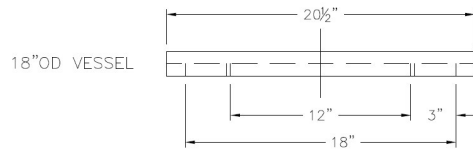
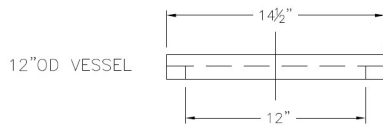

CART ELEVATION VIEW

**De Dietrich Process Systems, Inc.**

244 Sheffield Street  
Mountainside, NJ 07092

P 908.317.2585  
F 908.889.4960

[www.ddpsinc.com](http://www.ddpsinc.com)  
[sales@ddpsinc.com](mailto:sales@ddpsinc.com)





### Nozzle Schedule

Mark	Size	Rating	Type	Service
A	4"	ASME	Ferrule	Sight Glass
B	2"	ASME	Ferrule	Pressure Gauge
C	2"	ASME	Ferrule	Product Inlet
D	1"x3"	ASME	Ferrule	Spray Disc
E	1 1/2"	ASME	Ferrule	Filtrate Outlet
F	2"	ASME	Ferrule	Vent
G	1"	ASME	Ferrule	Nitrogen Pressure
H	1"	150#	RFSO	Steam In
J	1"	150#	RSSO	Steam Out

### Design Data

	Shell	Jacket/Tube
Design Pressure (PSIG)	50/-15	100
Design Temperature (°F)	250	250
M.A.W.P. (PSIG)	50/-15	100
M.D.M.T. (°F)	-20	-20
Radiographic Examination	None	None
Join Efficiency (%)	0.7	0.7

Filter Area	0.52m <sup>2</sup>
Nominal Diameter	32"
Working Volume	225L

### Weight (lbs.)

Erection (shipping) weight	760
Weight, full of water	1250

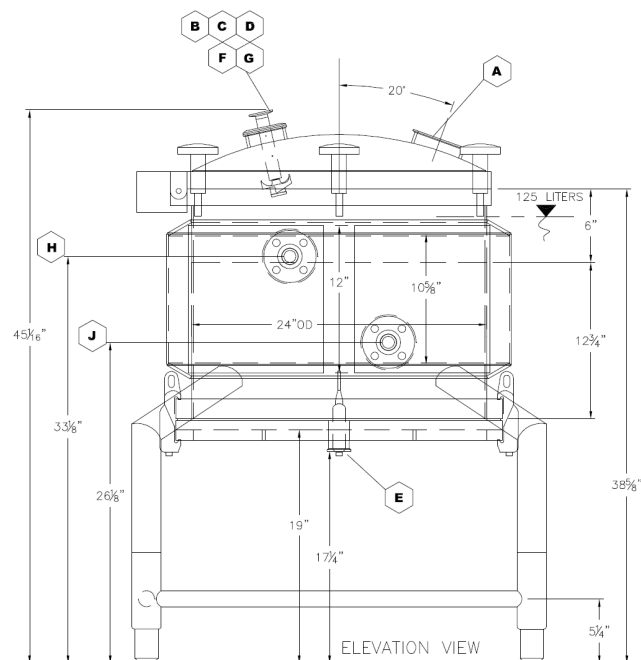
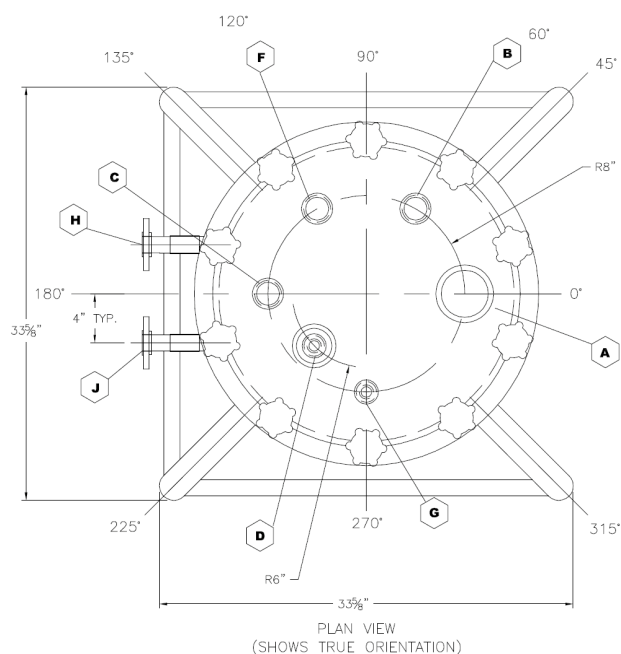



**ROSENMUND**

**ROMAN FILTER  
32-225L**

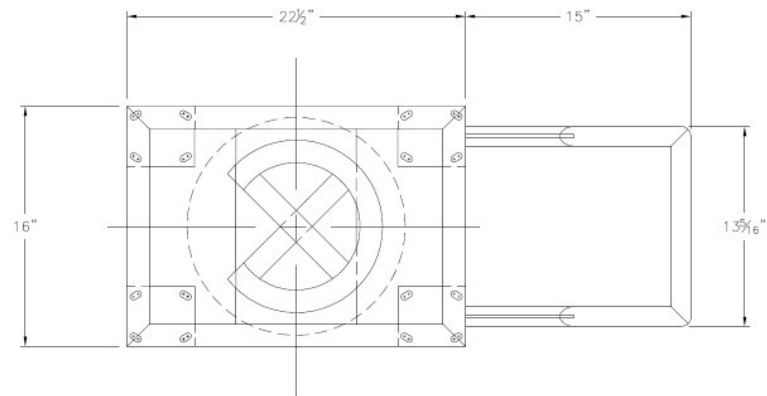

CART PLAN VIEW  
(SHOWS TRUE ORIENTATION)

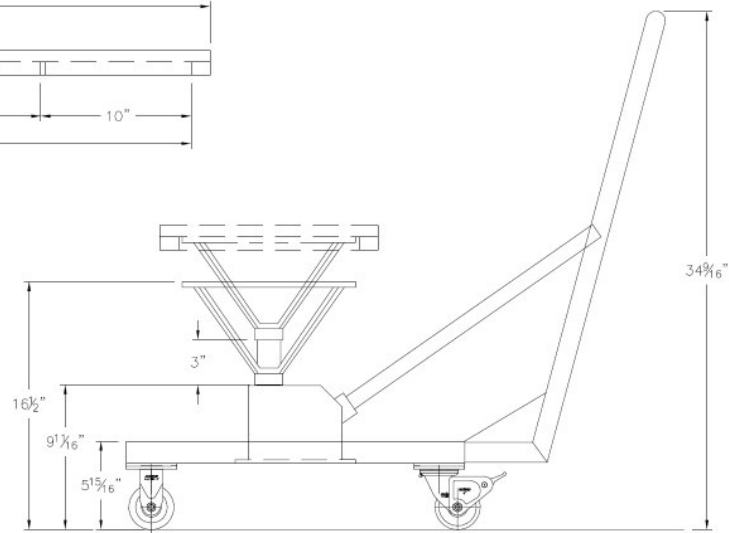
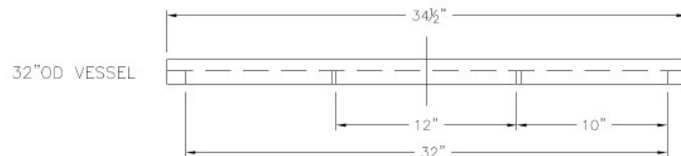
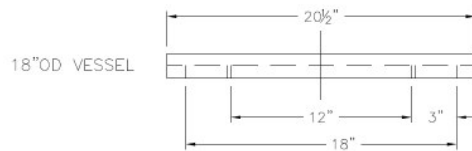
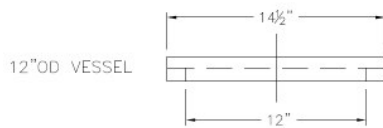

CART ELEVATION VIEW

**De Dietrich Process Systems, Inc.**

244 Sheffield Street  
Mountainside, NJ 07092

P 908.317.2585  
F 908.889.4960

[www.ddpsinc.com](http://www.ddpsinc.com)  
[sales@ddpsinc.com](mailto:sales@ddpsinc.com)

